



BACKPACK VACUUM SAFETY

READ THE BACKVAC USER GUIDE BEFORE YOU USE THE BACKVAC FOR THE FIRST TIME

SAFETY ADVICE

- Always adjust the waist harness and shoulder straps to comfortable positions.
- Adjust the telescopic wand to the correct length for you.
- Avoid bending over when vacuuming.

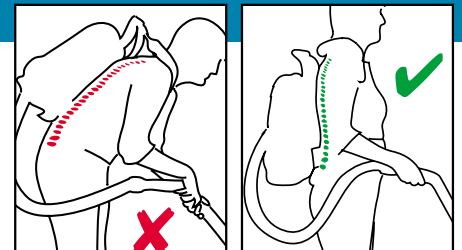

Do not use the backvac for long periods without rest periods.

- Always unwind the power cable completely.
- Ensure that the power cable is correctly plugged in and securely locked into the cable restraint.
- Do not use a damaged power cable and never carry the backvac by the cable.
- Do not pull the power cable around sharp edges or under doors.
- Do not unplug by pulling on the power cable
- Do not touch the power plug with wet hands.

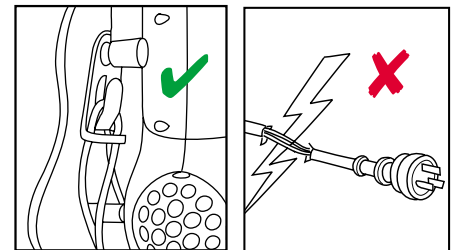

Do not use the backvac outdoors or on wet surfaces.



OPERATOR HEALTH PROTECTION

- Hold the backvac close to your body when lifting it. Place your arms through the shoulder straps and position the unit comfortable on your back.
- Close the waist harness snugly to make sure that the weight of the backvac is carried on your hips and not on the shoulders.
- Ease the shoulder straps off slightly so that you can move your arms freely and can bend your back without any constraint from the backvac.
- Adjust the length of the telescopic wand so that your arm holding the handpiece is comfortably hanging by your side when you stand upright.

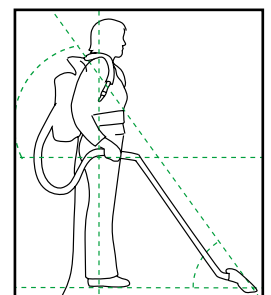

A PROPERLY ADJUSTED AND CORRECTLY WORN BACKVAC WILL HELP TO PREVENT FATIGUE AND INJURY



BACKPACK VACUUM EFFICIENCY

**READ THE BACKVAC USER GUIDE BEFORE YOU USE
THE BACKVAC FOR THE FIRST TIME**

HOW TO PREPARE THE BACKVAC

Open the lid and ensure that the dustbag is empty and correctly located to provide a proper seal when the lid is closed. Fit a paper dustbag if required.

Ensure that the vacuum hose is correctly threaded into the lid. Reposition the lid with the hose on your preferred side.

Inspect the power cable to make sure it is not damaged and is correctly locked into the cable restraint.

HOW TO USE THE BACKVAC EFFECTIVELY

- Inspect the area to be vacuumed before you start to see which parts need detailed cleaning.
- Don't spend time cleaning areas that aren't dirty.
- Always unwind the power cable completely.

**Plan your progress so that the cable is behind you.
Avoid unnecessary backtracking in your vacuuming path.**

- Take care not to vacuum up oversize objects that may block the wand or the vacuum hose.
- Use the air by-pass valve on the handpiece to regulate the suction required for each job.

Be aware of your surroundings and remember that you are carrying the backvac.

- Avoid damaging furniture, the backvac or yourself.
- Remain upright when vacuuming, swing your arm in an easy motion and make use of appropriate rest periods.
- When you have finished, unfasten the waist harness and slide the machine off your back.
- Unplug the power cable and coil it from the machine end.

Empty and clean the dustbag.

- Carry the backvac by the handle and not by the power cable or the hose.

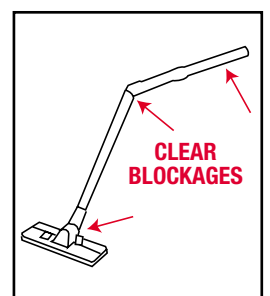
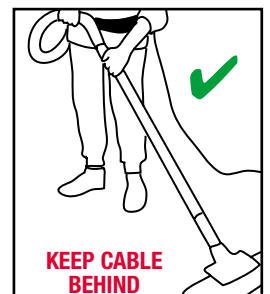



BACKPACK VACUUM MAINTENANCE

WHAT TO DO IF...

BACKVAC WON'T START

Check to see if the power switch is illuminated

If it is not:

- Ensure that the power cable is plugged in properly
- Ensure that there is power to the electrical outlet
- Inspect the power cable and replace it if it is damaged
- Ensure that the power cable is securely connected to the backvac

If it is: Have the backvac inspected by an authorised technician.

BACKVAC STOPS WORKING

The motor protection switch may have been activated because the dustbag is too full or there is a blockage in the wand, hose or accessories. Empty and clean the bag or remove the blockage. Wait for 30 minutes and then switch the backvac on.

BACKVAC HAS NO SUCTION

Ensure that the dustbag and the lid are fitted correctly to provide a proper air seal. Ensure that the hose is securely connected to the lid and the accessories. Ensure that the dustbag is empty and clean and that there are no blockages in the wand, hose or accessories.

BACKVAC HAS SUCKED UP WATER

The backvac may be used for Dry Vacuum Only. If water is sucked up, switch off the power to the machine immediately. Unplug the power cable. Empty the dustbag and let it dry. **DO NOT** use the backvac until it has been inspected by an authorised technician.

HOSE DETACHES FROM THE LID

Refit the hose by screwing it into the lid in an anti-clockwise direction.

HOSE DETACHES FROM THE HANDPIECE

Undo the clip ring in the handpiece and place it onto the hose. Locate the screw hub inside the handpiece and screw it onto the hose in an anti-clockwise direction. Insert the screw hub in to the handpiece and push the clip ring into place.

POWER CABLE IS TWISTED

Fully extend the power cable and unwind all twists. Keep rotating the cable until it is straight again. Always rewind the power cable from the machine towards the plug. Inspect the power cable for any damage.